

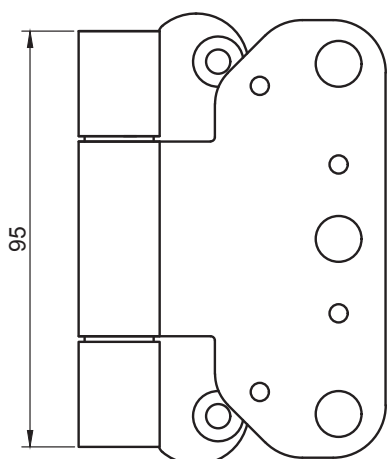

- thickness of material: 3 mm
- teflon bearings - maintenance not required
- screwed to the leaf and the frame; non-adjustable
- **DFM designed: installation anchors led through holes in hinge blades to assure rigid assembly in wall**
- Certificate of Constancy of Performance according to EN 1925 standard

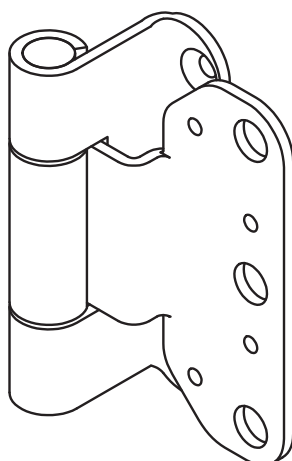

→ non-adjustable hinge,
size



→ non-adjustable hinge,
view

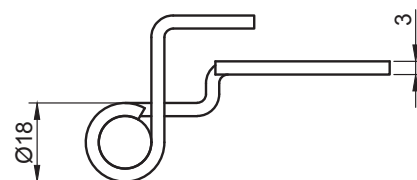

→ horizontal section

finish:
stainless steel 1.4301
(AISI 304)

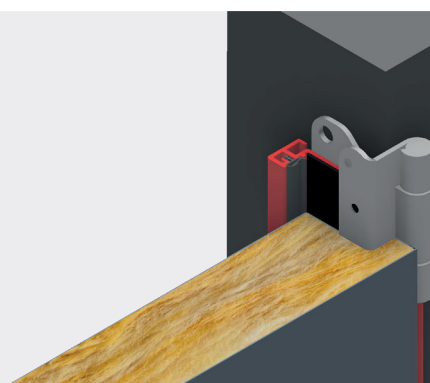

standard for doors

DFM DS 00
DFM DS 30
DFM DS 30B
DFM DS 60
DFM DS 60B-1



- thickness of material: 3 mm
- teflon bearings – maintenance not required
- hinge load capacity (2pcs for 1 leaf) – 100 kg
- screwed to the leaf and the frame; adjustable in 3D
- **DFM designed: installation anchors led through holes in hinge blades to assure rigid assembly in wall**
- cutouts in wall are necessary in the case of corner and embracing frames
- Certificate of Constancy of Performance according to EN 1925 standard

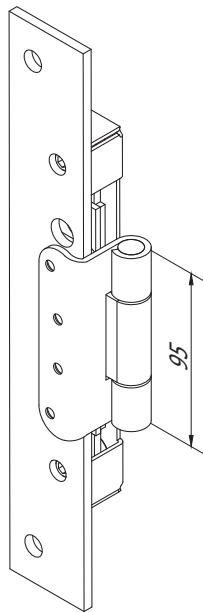

→ 3D adjustable hinge, view

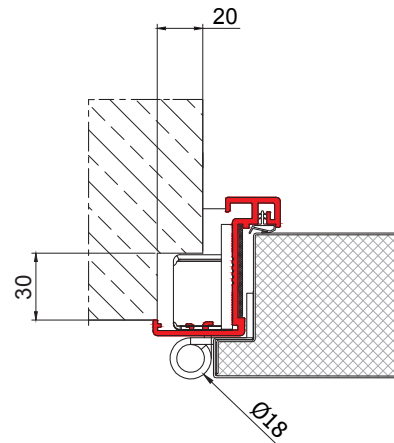

→ horizontal section

finish:
stainless steel 1.4301
(AISI 304)

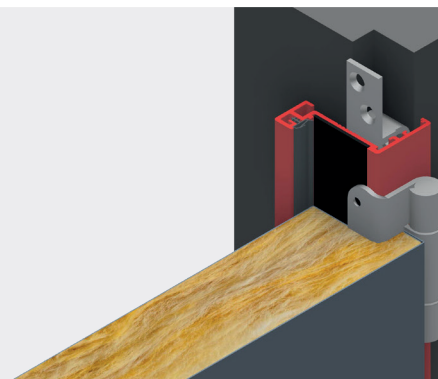

alternative for doors

DFM DS 00
DFM DS 30
DFM DS 30B
DFM DS 60
DFM DS 60B-1



- thickness of material: 4 mm
- teflon bearings - maintenance not required
- hinge load capacity (2pcs for 1 leaf) - 160kg
- screwed to the leaf and the frame; adjustable in 3D
- **DFM designed: installation anchors led through holes in hinge blades to assure rigid assembly in wall**
- cutouts in wall are necessary in the case of corner and embracing frames
- Certificate of Constancy of Performance according to EN 1925 standard

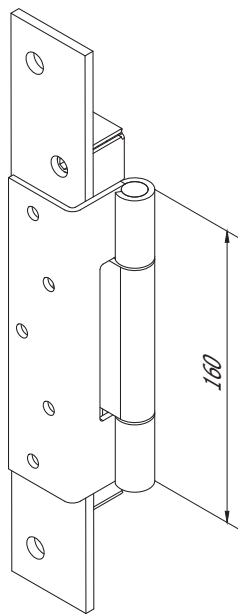

→ 3D adjustable hinge, view

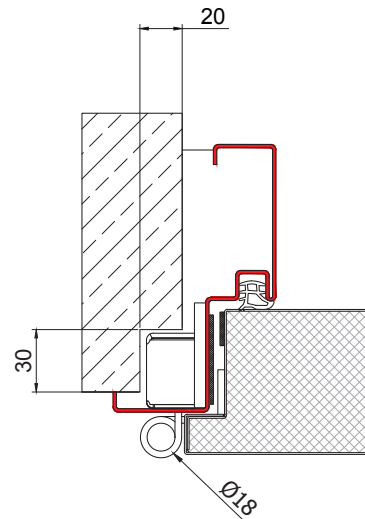

→ horizontal section

finish:
stainless steel 1.4301
(AISI 304)

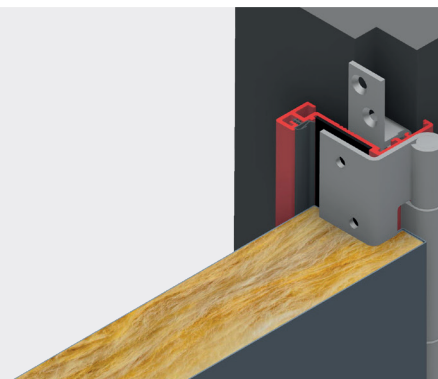

for doors
of considerable
door leaf weight
DFM DS 120
DFM OS